

KEY

- Traffic cone
- Race Route

EVENT ORGANISER
TO PROVIDE
MARSHALS AT ALL
ROAD CLOSED
SIGNS TO ADVISE
PERMITTED
MOVEMENT

WARNING
No vehicles, equipment
or non TM operatives
permitted in the taper /
longways safety zone or
sideways safety zone

| | | | |
|---|------------|--------------|-------|
| DRAWING STATUS | REVIEW | SCHEME | EVENT |
| <div>GRAHAM</div> | | | |
| PROJECT | | | |
| BELFAST 5K | | | |
| TITLE | | | |
| BELFAST CITY CENTRE TRAFFIC MANAGEMENT DETAILS TM SETUP | | | |
| DESIGN CHECKLIST | | | Y/N |
| 1- ARE ADVANCED NOTICE SIGNS/VMS SHOWN? | | | N/A |
| 2- ARE RELEVANT DISCLAIMERS SHOWN? | | | Y |
| 3- ARE PSNI LOCATIONS SHOWN? | | | N/A |
| 4- ARE MARSHALL LOCATIONS SHOWN AT ROAD CLOSED SIGNS? | | | Y |
| 5- ARE MARSHAL LOCATIONS SHOWN AT CENTRE LINE CONING? | | | N/A |
| KEY | | | |
| <div><div>●</div> PSNI</div> <div><div>●</div> Marshalls at Road Closed Signs (Marshalls to advise motorists of permitted movements - i.e no vehicles allowed onto marathon route from a side street)</div> | | | |
| APPROVED BY | | | |
| EVENT ORGANISER | | | |
| EVENT TRAFFIC MANAGEMENT DOES NOT COMPLY WITH CH 8, PLEASE REFER TO CLAUSE 2.5 OF OUR TERMS OF BUSINESS FOR FURTHER INFORMATION | | | |
| SCALE | DATE | DESIGN/DRAWN | SHT |
| N.T.S | 30/07/2024 | JCH | A3 |
| DRAWING TITLE | | | REV. |
| BELFAST 5K - 01 | | | 0 |

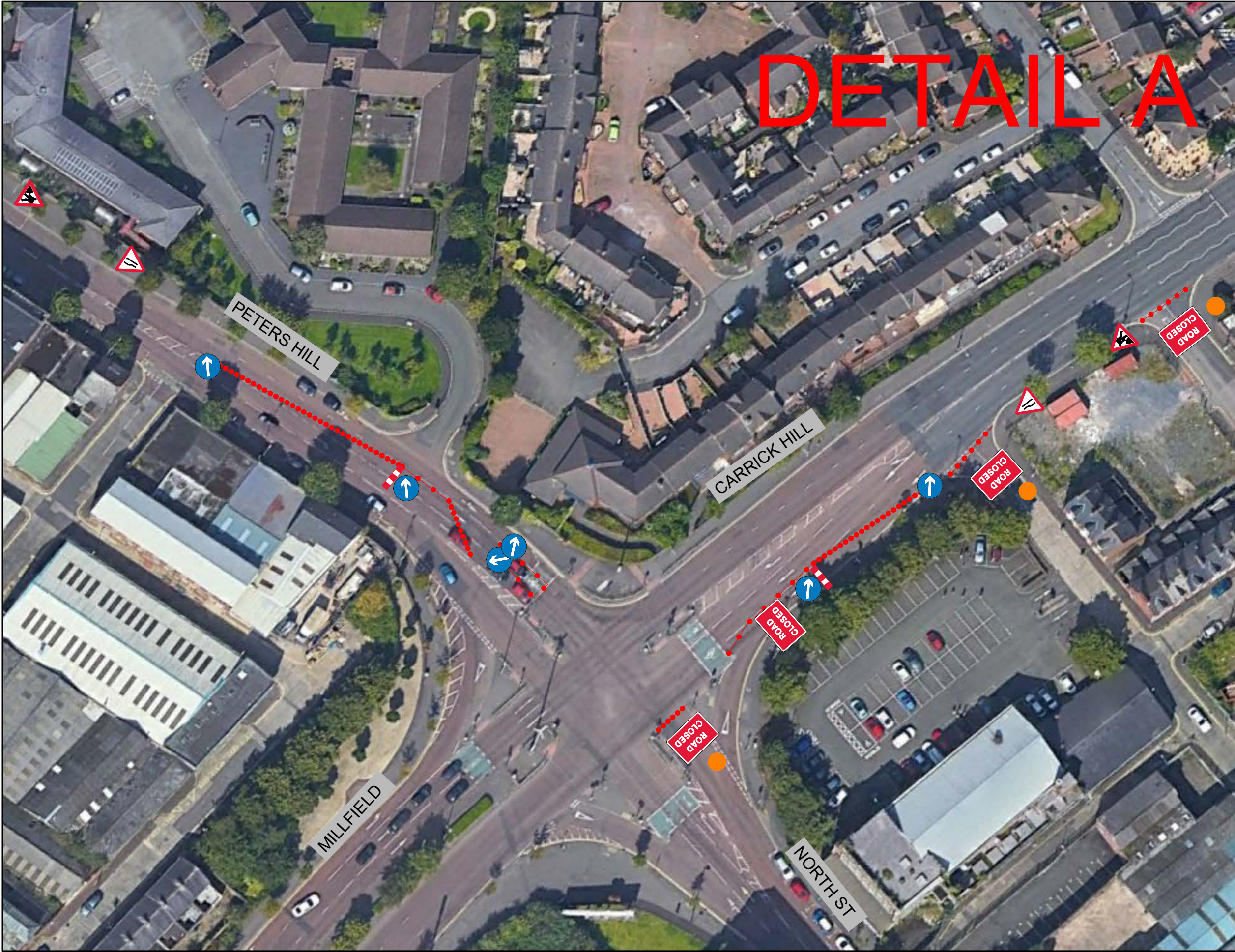

KEY

- Traffic cone
- ←→ Race Route

EVENT ORGANISER
TO PROVIDE
MARSHALS AT ALL
ROAD CLOSED
SIGNS TO ADVISE
PERMITTED
MOVEMENT

WARNING
No vehicles, equipment
or non TM operatives
permitted in the taper /
longways safety zone or
sideways safety zone

| DRAWING STATUS | | REVIEW | SCHEME | EVENT |
|---|------------|---|--------|-------|
| GRAHAM | | | | |
| PROJECT | | BELFAST 5K | | |
| TITLE | | BELFAST CITY CENTRE TRAFFIC MANAGEMENT DETAILS TM SETUP | | |
| DESIGN CHECKLIST | | | | Y/N |
| 1- ARE ADVANCED NOTICE SIGNS/VMS SHOWN? | | | | N/A |
| 2- ARE RELEVANT DISCLAIMERS SHOWN? | | | | Y |
| 3- ARE PSNI LOCATIONS SHOWN? | | | | N/A |
| 4- ARE MARSHALL LOCATIONS SHOWN AT ROAD CLOSED SIGNS? | | | | Y |
| 5- ARE MARSHAL LOCATIONS SHOWN AT CENTRE LINE CONING? | | | | N/A |
| KEY | | | | |
| ● PSNI | | | | |
| ● Marshalls at Road Closed Signs (Marshalls to advise motorists of permitted movements - i.e no vehicles allowed onto marathon route from a side street) | | | | |
| APPROVED BY | | EVENT ORGANISER | | |
| EVENT TRAFFIC MANAGEMENT DOES NOT COMPLY WITH CH 8. PLEASE REFER TO CLAUSE 2.5 OF OUR TERMS OF BUSINESS FOR FURTHER INFORMATION | | | | |
| SCALE | DATE | DESIGN/DRAWN | SHT | |
| N.T.S | 30/07/2024 | JCH | A3 | |
| DRAWING TITLE | | | | REV. |
| BELFAST 5K - 02 | | | | 0 |



KEY

- Traffic cone
- ←→ Race Route

EVENT ORGANISER
TO PROVIDE
MARSHALS AT ALL
ROAD CLOSED
SIGNS TO ADVISE
PERMITTED
MOVEMENT

WARNING
No vehicles, equipment
or non TM operatives
permitted in the taper /
longways safety zone or
sideways safety zone

| | | | |
|---|--|--------------|-------|
| DRAWING STATUS | REVIEW | SCHEME | EVENT |
| GRAHAM | | | |
| PROJECT | BELFAST 5K | | |
| TITLE | BELFAST CITY CENTRE TRAFFIC MANAGEMENT DETAILS TM SETUP | | |
| DESIGN CHECKLIST | | | |
| 1- ARE ADVANCED NOTICE SIGNS/VMS SHOWN? | N/A | | |
| 2- ARE RELEVANT DISCLAIMERS SHOWN? | Y | | |
| 3- ARE PSNI LOCATIONS SHOWN? | N/A | | |
| 4- ARE MARSHALL LOCATIONS SHOWN AT ROAD CLOSED SIGNS? | Y | | |
| 5- ARE MARSHAL LOCATIONS SHOWN AT CENTRE LINE CONING? | N/A | | |
| KEY | | | |
| ● PSNI | | | |
| ● Marshalls at Road Closed Signs (Marshalls to advise motorists of permitted movements - i.e no vehicles allowed onto marathon route from a side street) | | | |
| APPROVED BY | EVENT ORGANISER EVENT TRAFFIC MANAGEMENT DOES NOT COMPLY WITH CH 8. PLEASE REFER TO CLAUSE 2.5 OF OUR TERMS OF BUSINESS FOR FURTHER INFORMATION | | |
| SCALE | DATE | DESIGN/DRAWN | SHT |
| N.T.S | 30/07/2024 | JCH | A3 |
| DRAWING TITLE | BELFAST 5K - 03 | | REV. |
| | | 0 | |

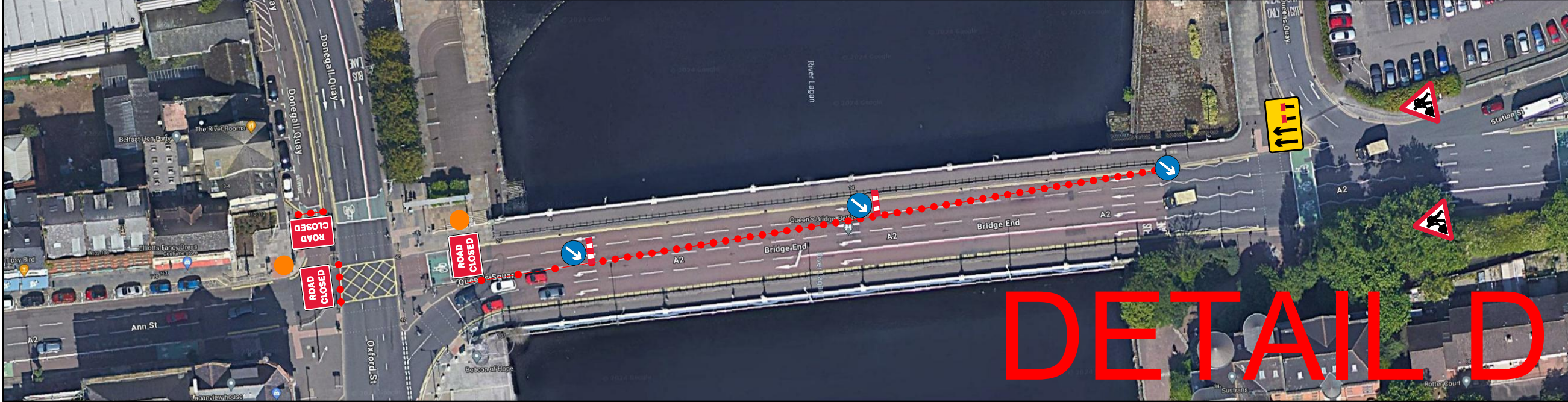
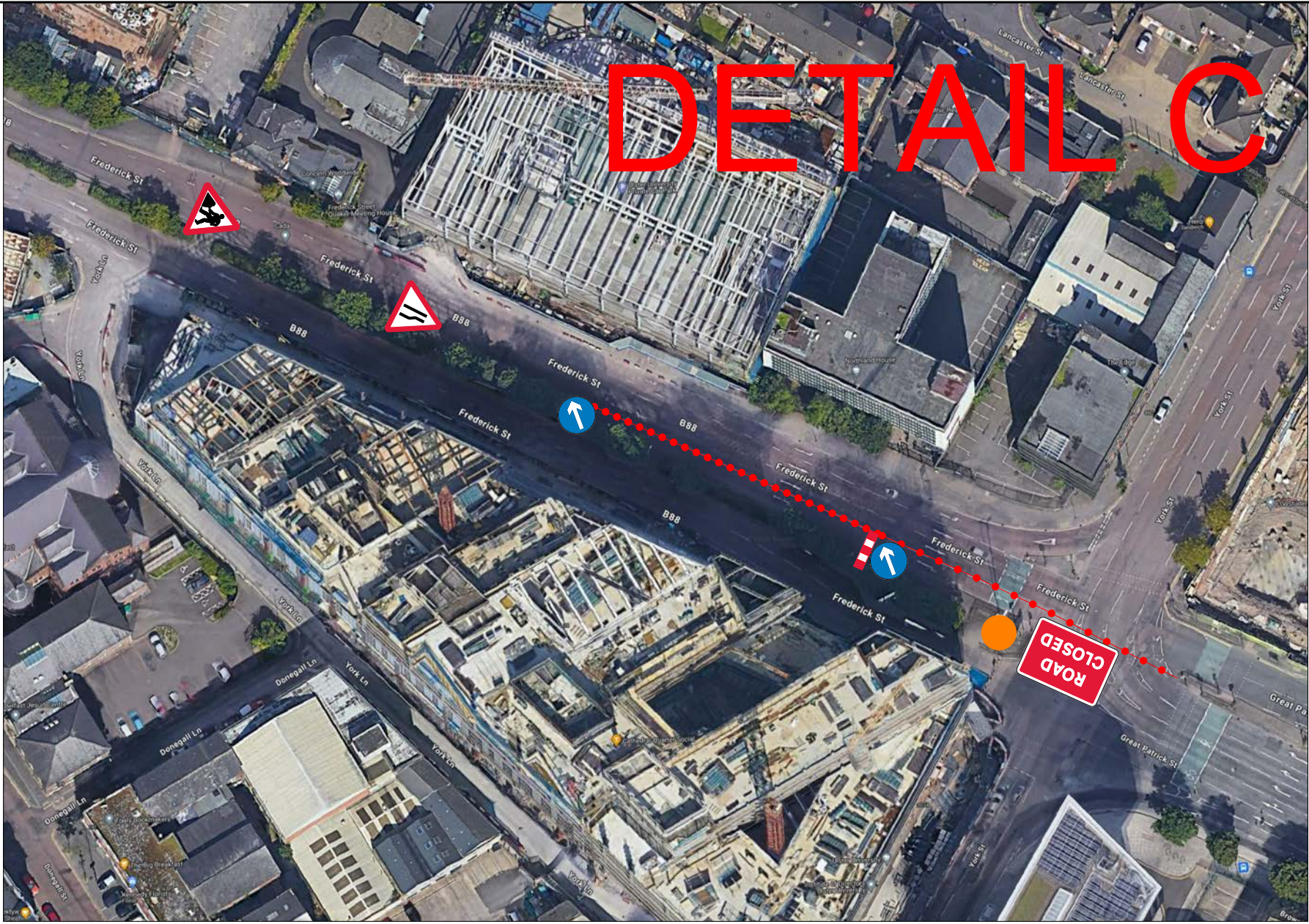
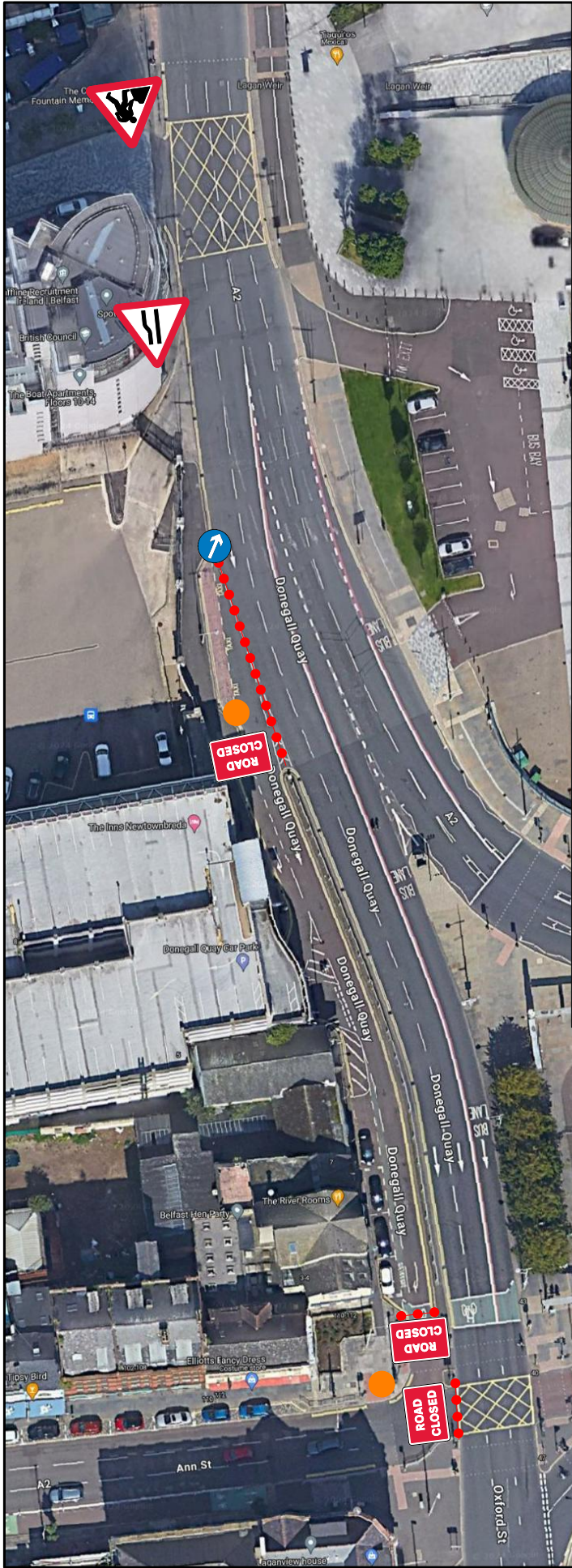

DETAIL C

DETAIL D

KEY

Traffic cone

Race Route

EVENT ORGANISER
TO PROVIDE
MARSHALS AT ALL
ROAD CLOSED
SIGNS TO ADVISE
PERMITTED
MOVEMENT

WARNING

No vehicles, equipment
or non TM operatives
permitted in the taper /
longways safety zone or
sideways safety zone

| | | | |
|---|---|--------------|-------|
| DRAWING STATUS | REVIEW | SCHEME | EVENT |
| GRAHAM | | | |
| PROJECT | BELFAST 5K | | |
| TITLE | BELFAST CITY CENTRE TRAFFIC MANAGEMENT DETAILS TM SETUP | | |
| DESIGN CHECKLIST | Y/N | | |
| 1- ARE ADVANCED NOTICE SIGNS/VMS SHOWN? | N/A | | |
| 2- ARE RELEVANT DISCLAIMERS SHOWN? | Y | | |
| 3- ARE PSNI LOCATIONS SHOWN? | N/A | | |
| 4- ARE MARSHAL LOCATIONS SHOWN AT ROAD CLOSED SIGNS? | Y | | |
| 5- ARE MARSHAL LOCATIONS SHOWN AT CENTRE LINE CONING? | N/A | | |
| KEY | <div><div></div><div>PSNI</div></div> <div><div></div><div>Marshalls at Road Closed Signs (Marshalls to advise motorists of permitted movements - i.e no vehicles allowed onto marathon route from a side street)</div></div> | | |
| APPROVED BY | EVENT ORGANISER | | |
| EVENT TRAFFIC MANAGEMENT DOES NOT COMPLY WITH CH 8. PLEASE REFER TO CLAUSE 2.5 OF OUR TERMS OF BUSINESS FOR FURTHER INFORMATION | | | |
| SCALE | DATE | DESIGN/DRAWN | SHT |
| N.T.S | 30/07/2024 | JCH | A3 |
| DRAWING TITLE | BELFAST 5K - 04 | | REV |
| | | | 0 |

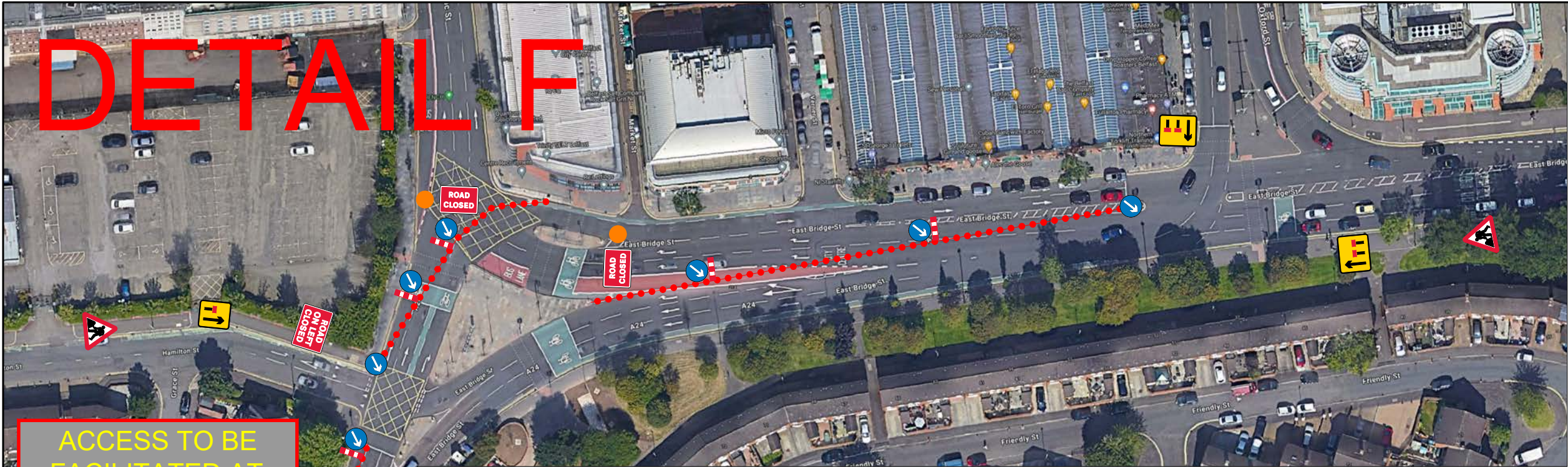

ACCESS TO BE FACILITATED AT HAMILTON ST/ JOY ST JUNCTION FOR CENTRAL CHURCH



KEY

- Traffic cone
- ←→ Race Route

EVENT ORGANISER TO PROVIDE MARSHALS AT ALL ROAD CLOSED SIGNS TO ADVISE PERMITTED MOVEMENT

WARNING
No vehicles, equipment or non TM operatives permitted in the taper / longways safety zone or sideways safety zone

| | | | |
|---|---|-------------|-------|
| DRAWING STATUS | REVIEW | SCHEME | EVENT |
| GRAHAM | | | |
| PROJECT | BELFAST 5K | | |
| TITLE | BELFAST CITY CENTRE TRAFFIC MANAGEMENT DETAILS TM SETUP | | |
| DESIGN CHECKLIST | | Y/N | |
| 1- ARE ADVANCED NOTICE SIGNS/VMS SHOWN? | | N/A | |
| 2- ARE RELEVANT DISCLAIMERS SHOWN? | | Y | |
| 3- ARE PSNI LOCATIONS SHOWN? | | N/A | |
| 4- ARE MARSHALL LOCATIONS SHOWN AT ROAD CLOSED SIGNS? | | Y | |
| 5- ARE MARSHAL LOCATIONS SHOWN AT CENTRE LINE CONING? | | N/A | |
| KEY | | | |
| ● PSNI | | | |
| ● Marshalls at Road Closed Signs | | | |
| (Marshalls to advise motorists of permitted movements - i.e no vehicles allowed onto marathon route from a side street) | | | |
| APPROVED BY | | | |
| EVENT ORGANISER | | | |
| EVENT TRAFFIC MANAGEMENT DOES NOT COMPLY WITH CH 8, PLEASE REFER TO CLAUSE 2.5 OF OUR TERMS OF BUSINESS FOR FURTHER INFORMATION | | | |
| SCALE | DATE | DESIGNED BY | SHT |
| N.T.S | 30/07/2024 | JCH | A3 |
| DRAWING TITLE | | | REV. |
| BELFAST 5K - 05 | | | 0 |

DETAIL G



DETAIL H

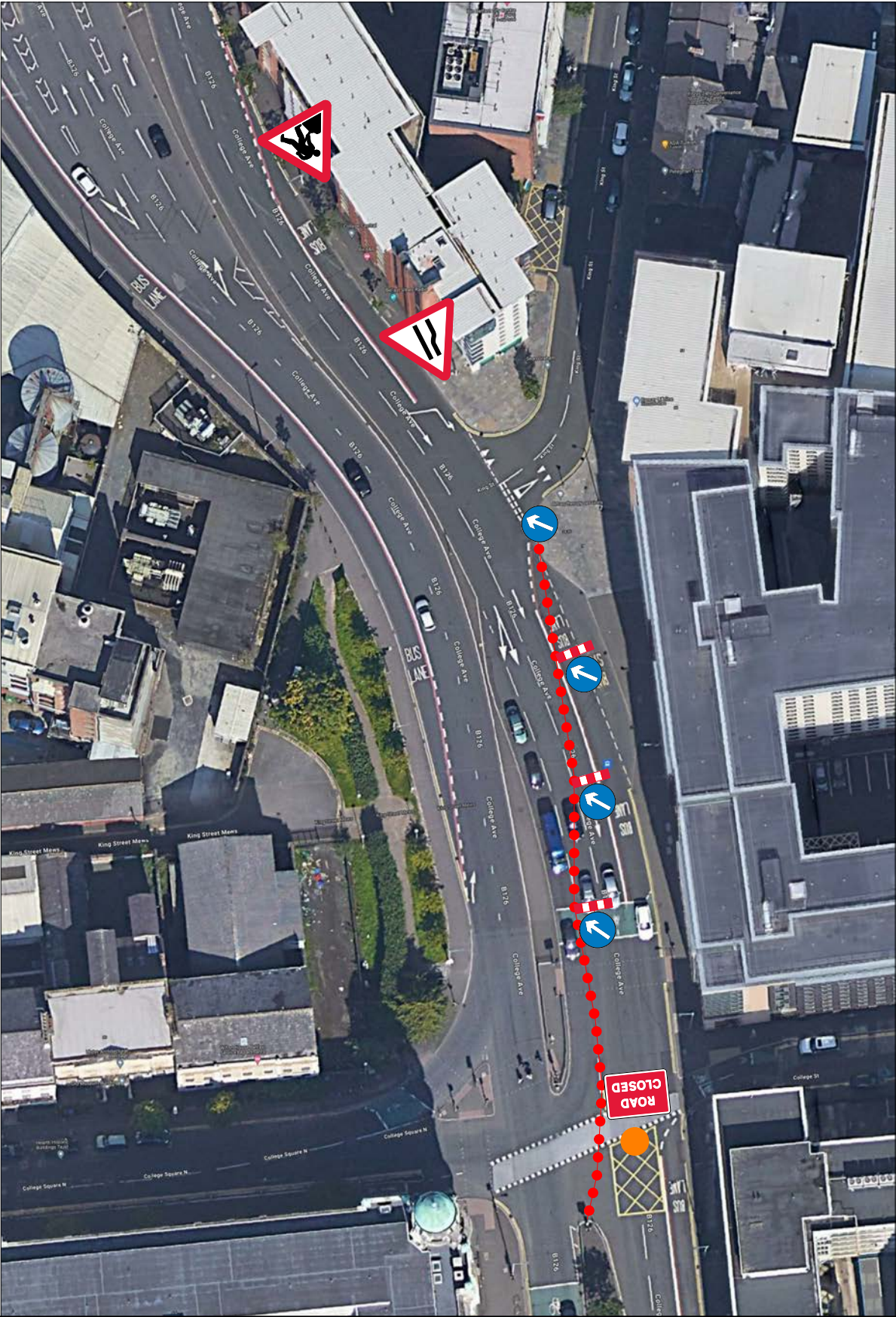

KEY

- Traffic cone
- ←→ Race Route

EVENT ORGANISER
TO PROVIDE
MARSHALS AT ALL
ROAD CLOSED
SIGNS TO ADVISE
PERMITTED
MOVEMENT

WARNING
No vehicles, equipment
or non TM operatives
permitted in the taper /
longways safety zone or
sideways safety zone

| DRAWING STATUS | | REVIEW | | SCHEME | | EVENT | |
|---|------------|---|--|--------|--|-------|--|
| <div>GRAHAM</div> | | | | | | | |
| PROJECT | | BELFAST 5K | | | | | |
| TITLE | | BELFAST CITY CENTRE TRAFFIC MANAGEMENT DETAILS TM SETUP | | | | | |
| DESIGN CHECKLIST | | | | | | Y/N | |
| 1- ARE ADVANCED NOTICE SIGNS/VMS SHOWN? | | | | | | N/A | |
| 2- ARE RELEVANT DISCLAIMERS SHOWN? | | | | | | Y | |
| 3- ARE PSNI LOCATIONS SHOWN? | | | | | | N/A | |
| 4- ARE MARSHALL LOCATIONS SHOWN AT ROAD CLOSED SIGNS? | | | | | | Y | |
| 5- ARE MARSHAL LOCATIONS SHOWN AT CENTRE LINE CONING? | | | | | | N/A | |
| KEY | | <div><div></div> PSNI</div> <div><div></div> Marshalls at Road Closed Signs (Marshalls to advise motorists of permitted movements - i.e no vehicles allowed onto marathon route from a side street)</div> | | | | | |
| APPROVED BY | | EVENT ORGANISER EVENT TRAFFIC MANAGEMENT DOES NOT COMPLY WITH CH 8. PLEASE REFER TO CLAUSE 2.5 OF OUR TERMS OF BUSINESS FOR FURTHER INFORMATION | | | | | |
| SCALE | DATE | DESIGN/DRAWN | | | | SHT | |
| N.T.S | 30/07/2024 | JCH | | | | A3 | |
| DRAWING TITLE | | | | | | REV. | |
| BELFAST 5K - 06 | | | | | | 0 | |



KEY

- Traffic cone
- ←→ Race Route



EVENT ORGANISER
TO PROVIDE
MARSHALS AT ALL
ROAD CLOSED
SIGNS TO ADVISE
PERMITTED
MOVEMENT

WARNING
No vehicles, equipment
or non TM operatives
permitted in the taper /
longways safety zone or
sideways safety zone

| DRAWING STATUS | REVIEW | SCHEME | EVENT |
|---|---|-------------|-------|
| GRAHAM | | | |
| PROJECT | BELFAST 5K | | |
| TITLE | BELFAST CITY CENTRE TRAFFIC MANAGEMENT DETAILS TM SETUP | | |
| DESIGN CHECKLIST | | | |
| 1- ARE ADVANCED NOTICE SIGNS/VMS SHOWN? | Y/N | | |
| 2- ARE RELEVANT DISCLAIMERS SHOWN? | N/A | | |
| 3- ARE PSNI LOCATIONS SHOWN? | Y | | |
| 4- ARE MARSHAL LOCATIONS SHOWN AT ROAD CLOSED SIGNS? | N/A | | |
| 5- ARE MARSHAL LOCATIONS SHOWN AT CENTRE LINE CONING? | Y | | |
| KEY | | | |
| ● PSNI | | | |
| ● Marshalls at Road Closed Signs (Marshalls to advise motorists of permitted movements - i.e no vehicles allowed onto marathon route from a side street) | | | |
| APPROVED BY | EVENT ORGANISER | | |
| EVENT TRAFFIC MANAGEMENT DOES NOT COMPLY WITH CH 8. PLEASE REFER TO CLAUSE 2.5 OF OUR TERMS OF BUSINESS FOR FURTHER INFORMATION | | | |
| SCALE | DATE | DESIGNED BY | SHT |
| N.T.S | 30/07/2024 | JCH | A3 |
| DRAWING TITLE | BELFAST 5K - 07 | | REV. |
| | | | 0 |



KEY

-  Traffic cone
-  Race Route

**EVENT ORGANISER
TO PROVIDE
MARSHALS AT ALL
ROAD CLOSED
SIGNS TO ADVISE
PERMITTED
MOVEMENT**

WARNING
No vehicles, equipment
or non TM operatives
permitted in the taper /
longways safety zone or
sideways safety zone



DRAWING STATUS REVIEW EVENT

GRAHAM

PROJECT BELFAST 5K

TITLE BELFAST CITY CENTRE
TRAFFIC MANAGEMENT DETAILS
TM SETUP

| DESIGN CHECKLIST | Y/N |
|--|-----|
| 1- ARE ADVANCED NOTICE SIGNS/VMS SHOWN? | N/A |
| 2- ARE RELEVANT DISCLAIMERS SHOWN? | Y |
| 3- ARE PSNI LOCATIONS SHOWN? | N/A |
| 4- ARE MARSHALL LOCATIONS SHOWN AT ROAD CLOSED SIGNS? | Y |
| 5- ARE MARSHALL LOCATIONS SHOWN AT CENTRE LINE CONING? | N/A |

KEY
 PSNI
 Marshalls at Road Closed Signs
(Marshalls to advise motorists of permitted movements - i.e no vehicles allowed onto marathon route from a side street)

APPROVED BY EVENT ORGANISER
EVENT TRAFFIC MANAGEMENT DOES NOT COMPLY
WITH CH 8. PLEASE REFER TO CLAUSE 2.5 OF OUR
TERMS OF BUSINESS FOR FURTHER INFORMATION

SCALE DATE DESIGNER SHT
N.T.S 30/07/2024 JCH A3

DRAWING TITLE BELFAST 5K - 08 REV. 0